

- NOTE:**
- PIPE ELEVATIONS ARE ESTABLISHED FROM CITY OF WINNIPEG RECORD DRAWINGS AND KGS SURVEY DONE ON THE 27 JUNE 2012.
  - ALL EXCAVATED MATERIAL TO BE MOVED OFF SITE. NO STOCK PILING OF MATERIAL.
  - PVC PIPE TO BE INSTALLED USING TRENCHLESS METHODS
  - ONE LANE OF TRAFFIC TO BE MAINTAINED IN EACH DIRECTION AT ALL TIMES. (MAY REQUIRE RELOCATION OF EXISTING JERSEY BARRIER)
  - LANE CLOSURES MUST BE COORDINATED WITH LORI GARET, P.ENG. AT THE CITY OF WINNIPEG (204-986-5900).
  - THE CONTRACTOR SHALL SUBMIT TRAFFIC MANAGEMENT CONTROL PLAN TO THE CONTRACT ADMINISTRATOR PRIOR TO COMMENCEMENT OF CONSTRUCTION.

**PROPERTY LIMITS DELINEATION**

DELINEATION OF PROPERTY LIMITS AS SHOWN ON THIS DWG DOES NOT REPRESENT A "LEGAL SURVEY". KGS GROUP MAKES NO REPRESENTATION OR WARRANTY AS TO THE ACCURACY OF PROPERTY LIMITS DELINEATED ON THIS DWG, NOR ON THE DIMENSIONAL ACCURACY OF DWG FEATURES RELATIVE TO THOSE PROPERTY LIMITS.

**WARNING**

- NOTIFY THE GAS COMPANY OF THE PROPOSED LOCATION OF EXCAVATION.
- TAKE PRECAUTION TO AVOID DAMAGE TO GAS COMPANY INSTALLATIONS.
- SEE PROVINCIAL REGULATION 210/72 FOR DETAILS.

**METRIC**

WHOLE NUMBERS INDICATE MILLIMETRES  
DECIMALIZED NUMBERS INDICATE METRES

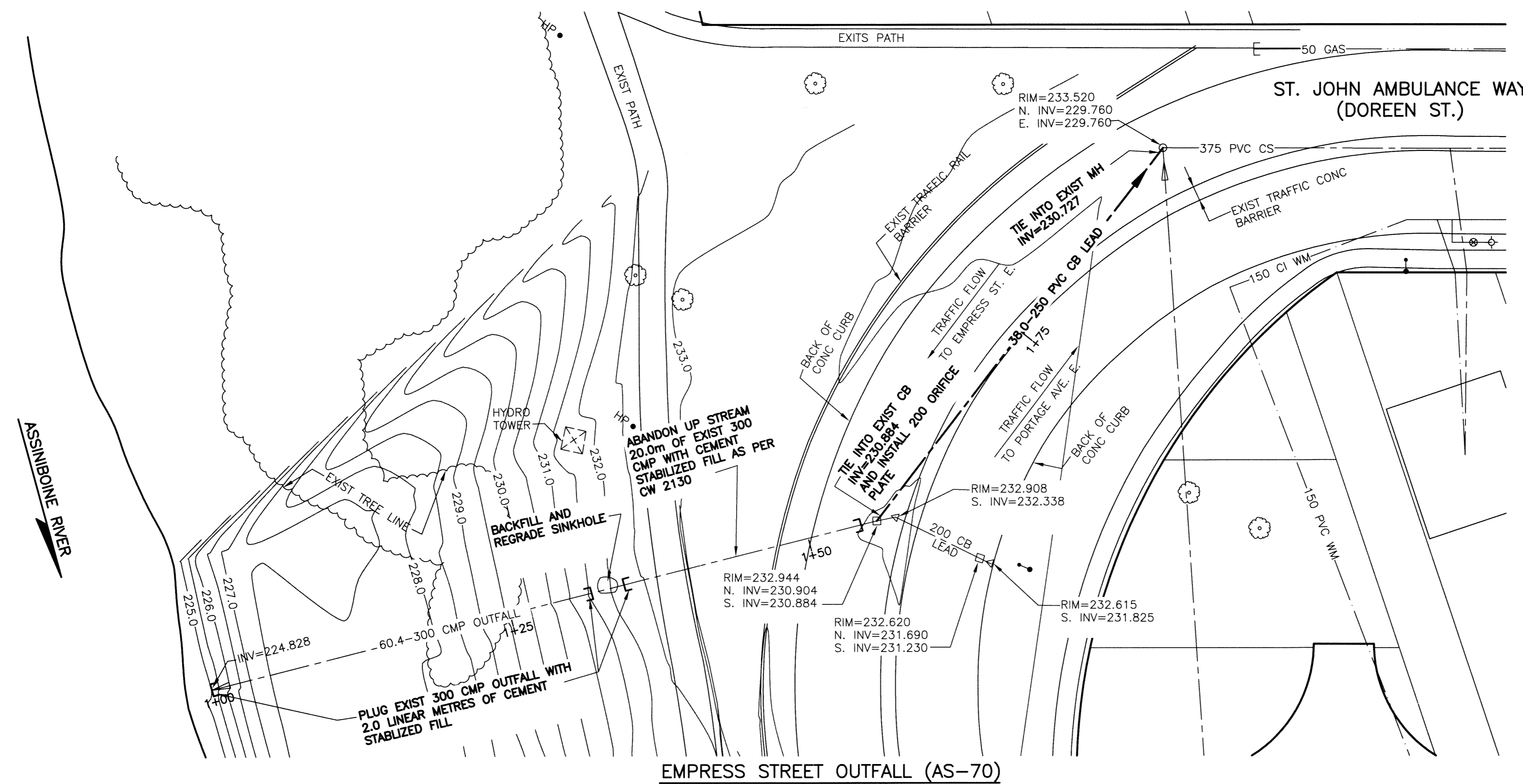
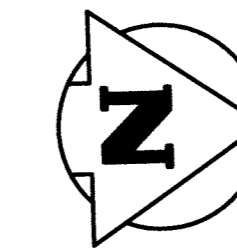
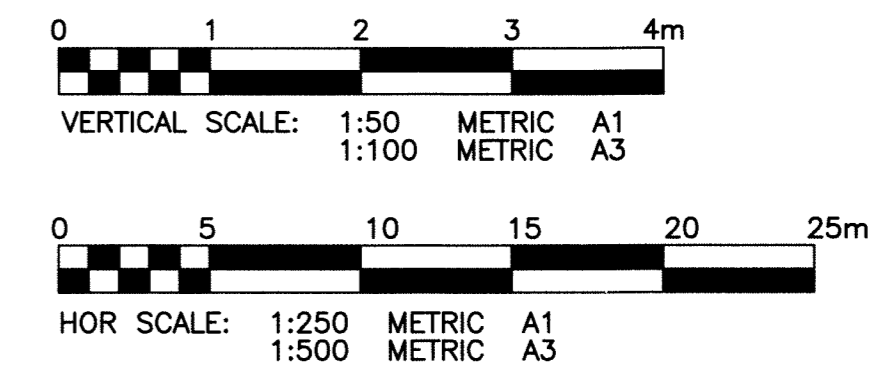

**APEGM**  
Certificate of Authorization  
KGS Group  
No. 245

File Name: E:\Projects\2011\11-0107-33\Doc\Control\ToBeIssued\DWG\11-0107-33\_LD-7018-Rev 0.dwg - Tab: LD-7018 Plotted By: DDerche 13/01/02 [Wed 4:28pm]  
 Plot Scale: 1:100

300 LBS	LAND DRAINAGE SEWER	300 LBS		TEST HOLE			
---	WASTE WATER SEWER	---	+	GUY WIRE			
---	GAS	---	-	LIGHT STANDARD			
---	HYDRO	---	•	BACK OF CURB			
---	M.T.S.	---	---	CONCRETE			
---	WATERMAIN	---	---	ASPHALT			
+	HYDRANT	+	+	SIDEWALK			
+	VALVE	+	+	PROPERTY LINE			
○	MANHOLE	○	○	SURVEY BAR			
□	CATCH BASIN	□	+	GEODETIC BENCHMARK			
▽	CURB INLET	▽	+	ELEVATION	(32.231)	TTTT	
•	POLES	•	+				
	LEGEND-PLAN			LEGEND-PROFILE			

**LOCATION APPROVED UNDERGROUND STRUCTURES**

SUPV. U/G STRUCTURES COMMITTEE DATE

**NOTE:**  
LOCATION OF UNDERGROUND STRUCTURES AS SHOWN ARE BASED ON THE BEST INFORMATION AVAILABLE BUT NO GUARANTEE IS GIVEN THAT ALL EXISTING UTILITIES ARE SHOWN OR THAT THE GIVEN LOCATIONS ARE EXACT. CONFIRMATION OF EXISTENCE AND EXACT LOCATION OF ALL SERVICES MUST BE OBTAINED FROM THE INDIVIDUAL UTILITIES BEFORE PROCEEDING WITH CONSTRUCTION.

NO.	REVISIONS	DATE	BY
0	ISSUED FOR TENDER	13/01/04	RBO

B.M. KGS BASE ELEV. -- DWGS BASED ON C.S.R.S. NAD 83 SYSTEM, UTM GRID

**KGS GROUP**  
CONSULTING ENGINEERS

DESIGNED BY	CHECKED BY
RBO	
DRAWN BY	APPROVED BY
DMW	
HOR. SCALE:	RELEASED FOR CONSTRUCTION:
1:250	
VERTICAL:	DATE
1:50	12/12/20

ENGINEER'S SEAL

PROVINCE OF MANITOBA  
REGISTERED PROFESSIONAL ENGINEER  
R.B. OFFMAN  
Member 24791

CONSULTANT DRAWING NO.  
11-0107-33\_01

**THE CITY OF WINNIPEG**  
WATER AND WASTE DEPARTMENT

PROJECT TITLE  
**2013 OUTFALL RENEWAL/REHABILITATION PROGRAM**

EMPRESS ST. OUTFALL #1 (AS-70)  
PLAN AND PROFILE

SHEET 03 OF 05  
COMPUTER FILE NAME  
11-0107-33\_01  
CITY DRAWING NUMBER  
LD-7018